

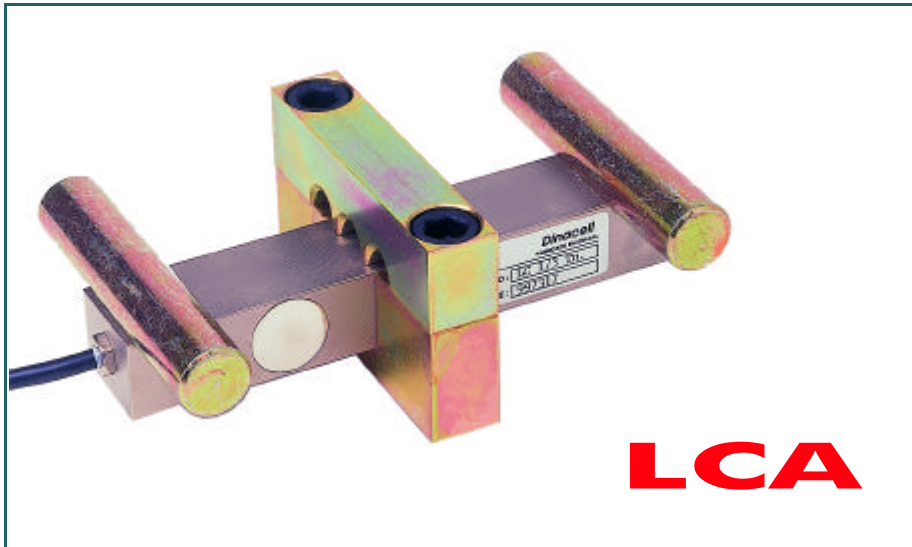

# ELEVATORS MOTORS CORPORATION

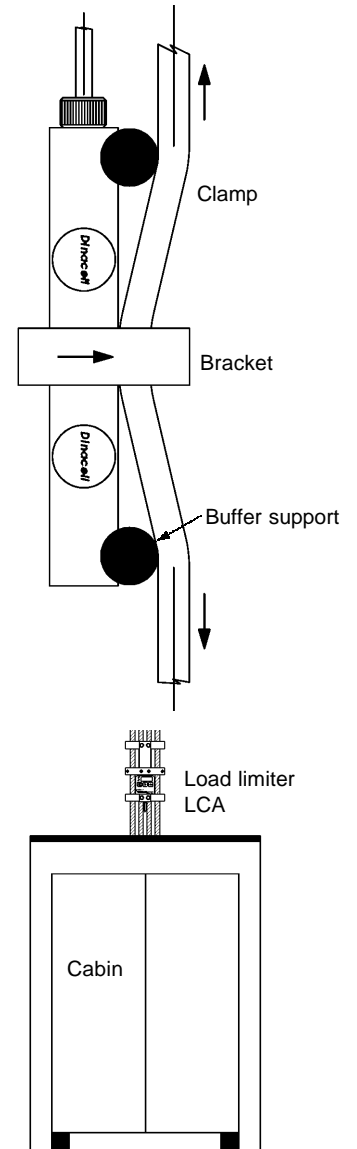

## Diagram of installation



- Load cell for installation in cables.
- This cell is manufactured with a high quality aluminum material in different capacities from 3.000 kg to 6.000 kg.
- The design has been optimized to obtain a maximum sensibility and in this way to get a minimum deviation in the trajectory of the cables.
- "Auto-calibrated" No need to introduce a well-known weight.
- For the installation it needs the accessory "Comprise clamp LCA".
- It is a model with a great precision and easy assembly, it is suitable for elevators and freight elevators already installed.

### 4 Threads connection

Excitation + . . . . . Red	Signal + . . . . . Green
Excitation - . . . . . Black	Signal - . . . . . White

### Technical Characteristic

Tension of excitement . . . . .	5...10V (max. 15V)
Non linearity . . . . .	<0.15 % F.E.
Non repeatability . . . . .	<0.15 % F.E.
Hysteresis . . . . .	<0.05 % F.E.
Combined error . . . . .	<0.2 % F.E.
Input resistance . . . . .	350 Ω ± 2
Output resistance . . . . .	350 Ω ± 2
Insulation resistance....( V. Test = 100V) . . . . .	>5.000x10 <sup>6</sup> Ω
Maximum work load . . . . .	150 % F.E.
Load limit without lost of characteristic . . . . .	200 % F.E.

## Dimensions of the LCA in mm

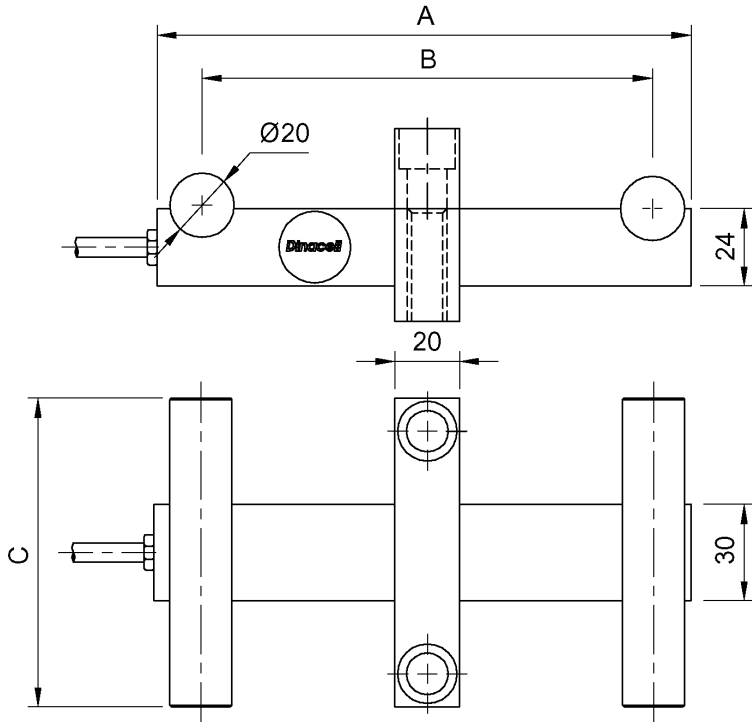

Capacities	Measures	
	A	B
3.000 kg	166	140
4.000 kg	166	140
6.000 kg	180	156

## Comprise clamp LCA

Type of clamp	Number of cables	C	Diameters of cables
8/13x3	3	96	8-9-10-11-12-13
8/13x4	4		
8/13x5	5		
8/13x6	6		
8/13x7	7		
8/13x8	8		

Asides from the standard, we manufactured other measures according to the clients request.

### Note

To carry out your orders, it is necessary to specify the numbers and the diameter of cables.

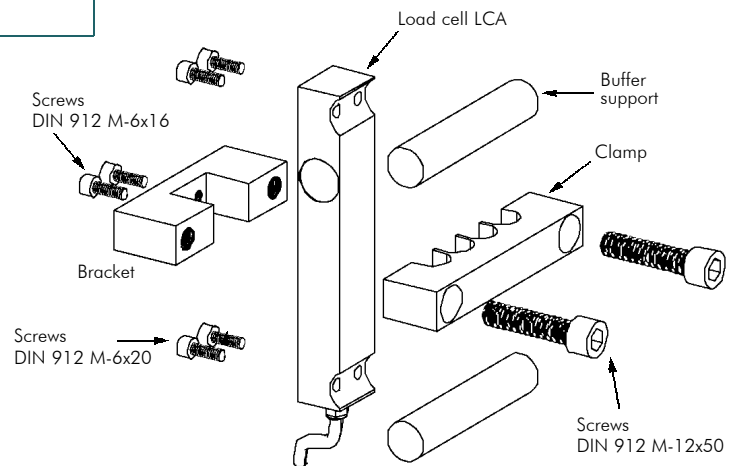

### STANDARD SCREWS

Screw DIN 912 M-6x16	2 pieces
Screw DIN 912 M-6x20	4 pieces
Screw DIN 912 M-12x15	2 pieces
Bracket	1 piece
Clamp	1 piece
Buffer support	2 pieces

## ELEVATORS MOTORS CORPORATION

80 Carolyn Boulevard. Farmingdale, NY 11735-1525

Phone (631) 293-4220. Fax (631) 293-2714. E-mail: info@elevatormotors.com